

**GRIPPS®**

**ANSI/ISEA  
121-2018  
COMPLIANT**

# H02049 RETRACTABLE SCAFFOLD KEY HOLSTER

*Designed specifically for use at elevated heights, the GRIPPS® Retractable Scaffold Key Holster ensures the secure and convenient storage of your scaffold key.*

Its lightweight yet durable industrial-grade design incorporates a Velcro flap to safeguard the keys during tasks performed at height.

Additionally, load-rated D-rings are integrated to serve as anchor points for tethering the scaffold key, further enhancing safety measures.



**2.5<sub>KG</sub> 5.5<sub>LB</sub>**

**MAX LOAD (D-RING)**

**0.7<sub>KG</sub> 1.5<sub>LB</sub>**

**MAX LOAD (RETRACTOR)**



**ENGINEERED FOR DROP PREVENTION**

**GRIPPS.COM**

## HOW TO USE

## KEY FEATURES

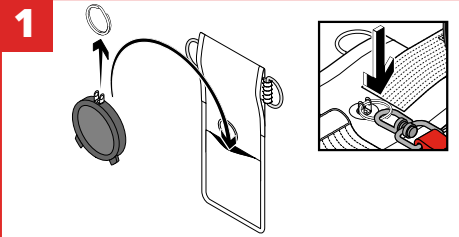

**1** Remove the tool ring from the retractor unit then insert into back pouch of holster. Reattach the tool ring, keeping it exposed outside the holster. Note some models require the ring fed through the center of holster and others via the side.

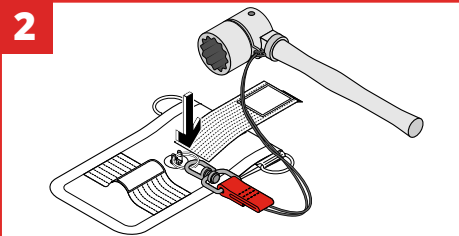

**2** Connect the tool to the retractor or side D-rings.

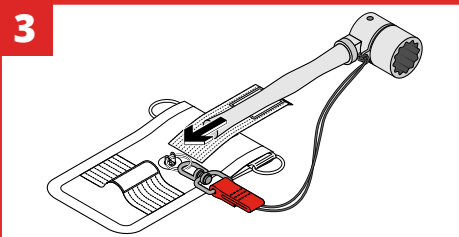

**3** Slide the tool into holster with the connection point applied to tool.

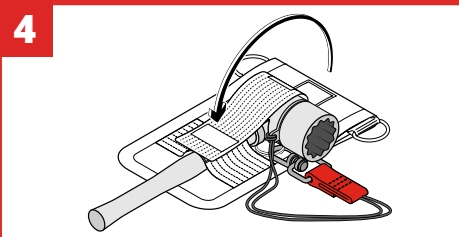

**4** Close the front strap.

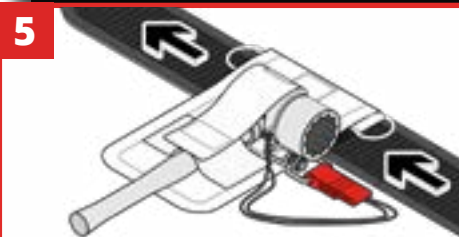

**5** Apply the holster to your work belt, by sliding the belt through the slip located on the upper end of the holster.

## SPECIFICATIONS

SKU	MAX LOAD (D-RING)	MAX LOAD (RETRACTOR)	MAX LENGTH (RETRACTOR)
H02049	2.5KG   5.5LB	0.7KG   1.5LB	1.2M   47"