

# GRIPPS®

ANSI/ISEA  
121-2023  
COMPLIANT

## H01141 MULE TOOL BACKPACK - 20KG / 44LB

*The GRIPPS® Mule Tool Backpack is an ANSI/ISEA 121-2023 compliant, lightweight and highly durable tool backpack. With a load rating of 20 kg (44lb), this innovative bag packs strength and is built for rugged work environments. The GRIPPS® Mule Tool Backpack is perfect for professionals working at height who seek compact functionality, safety, and overall reliability in a tool bag.*

This bag features internal and external anchor points, as well as load-rated mounting straps for handrails or scaffolding.



ENGINEERED FOR DROP PREVENTION

[gripps.com](http://gripps.com)

## KEY FEATURES

Lightweight, durable and robust design.

ANSI/ISEA 121-2023 compliant.

Load-rated mounting straps for attaching to rails and scaffolding.



1

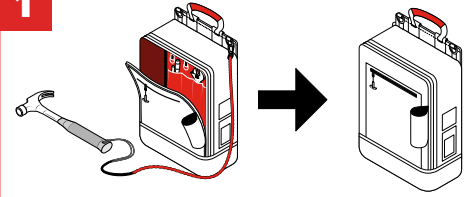

When transporting contents at height, ensure all zips are sealed.

2

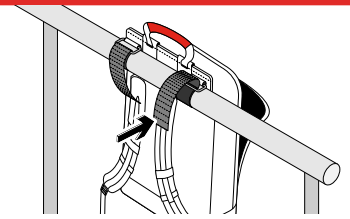

To secure to a rail, wrap the straps all the way around the rail and feed back through the metal bracket.

3

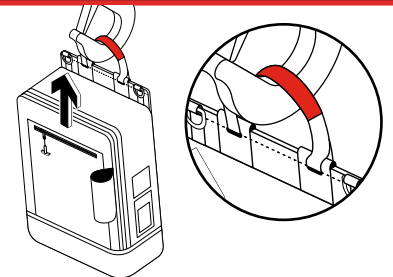

Ensure all tools are tethered to D-Rings and zips fully sealed. Attach lifting hook to the red upper lifting strap.

4

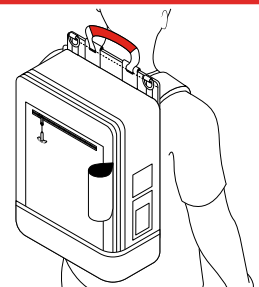

To manually transport, put arms through shoulder straps, and adjust length as required. Refer to your workplace guidance on safe manual handling guidelines.

## SPECIFICATIONS

SKU	MAX LOAD (D-RING)	MAX LOAD
H01141	2.5kg   5.5lb	20kg   44lb
HEIGHT	WIDTH	DEPTH
42cm   16in	32cm   13in	12cm   5in

ANSI/ISEA 121-2023 - Compliant  
 AS4991-2004 - Compliant  
 BS EN 1492-1+A1:2008 - Compliant

\*Last update 24.02.25

@GRIPPSGLOBAL



#ConquerGravity