

GRIPPS®

ANSI/ISEA
121-2023
COMPLIANT

H02077 RETRACTABLE DUAL TOOL HOLSTER (COMBO RETRACTORS)

The GRIPPS® Retractable Dual Tool Holster (Combo Retractors) is both lightweight and rugged with plenty of convenience. Providing two storage pouches, this holster is perfect for small hand tools. This holster includes a GRIPPS® Dual Tool Holster, a GRIPPS® Steel Cable Retractor Unit and a GRIPPS® Kevlar Retractor with Auto-Stop functionality.

The included GRIPPS® Kevlar Cable Retractor Unit With Auto-Stop allows free use of a tool, with a locking function preventing retraction of the Kevlar cable.



2.5 KG **5.5** LB

MAX LOAD (D-RING):

0.7 KG **1.5** LB

MAX LOAD (RETRACTOR):



ENGINEERED FOR DROP PREVENTION

gripps.com

KEY FEATURES

Compatible with all standard work belts



Kevlar Retractor Unit included.

Compatible with GRIPPS® Retractor Units.

2 x load-rated D-Rings.

Steel Retractor Unit included.

Lightweight design with industrial toughness.

Drain hole.

SPECIFICATIONS

SKU	MAX LOAD (D-RING)	MAX LOAD (RETRACTOR)	MAX LENGTH (RETRACTOR)
H02077	2.5kg 5.5lb	0.7kg 1.5lb	1.2m 47in

1

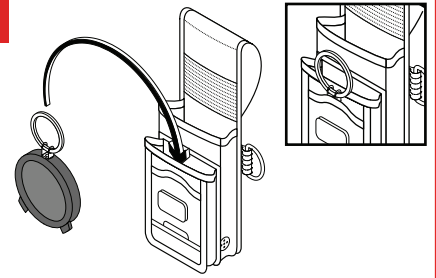

Insert the Retractor Unit into front pouch. Ensure tool ring is exposed outside holster.

2

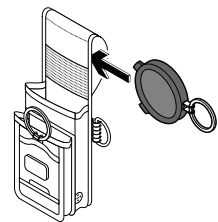

Insert second Retractor Unit into rear pouch. Ensure tool ring is exposed outside holster.

3

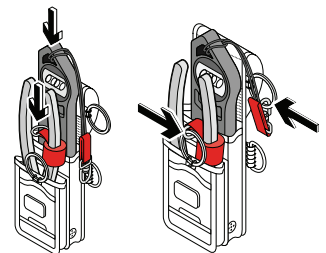

Connect tool to the Retractor or side D-Rings.

4

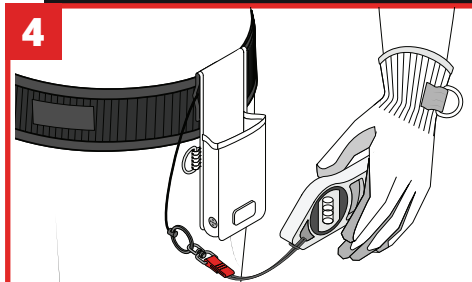

Your Dual Tool Holster is now ready for use