

GRIPPS®

**ANSI/ISEA
121-2018
COMPLIANT**

H02047 SCAFFOLD KEY HOLSTER

Designed specifically for use at elevated heights, the GRIPPS® Scaffold Key Holster ensures the secure and convenient storage of your scaffold key.

Its lightweight yet durable industrial-grade design incorporates a Velcro flap to safeguard the keys during tasks performed at height.

Additionally, load-rated D-rings are integrated to serve as anchor points for tethering the scaffold key, further enhancing safety measures.



2.5 KG **5.5** LB
MAX LOAD

ENGINEERED FOR DROP PREVENTION

GRIPPS.COM

HOW TO USE

KEY FEATURES

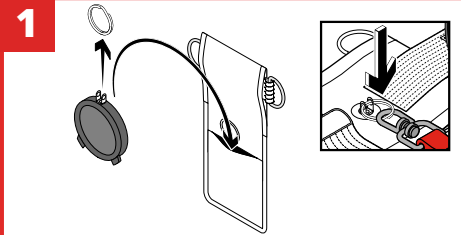

1 Remove tool ring from the retractor unit then insert into back pouch of holster. Reattach the tool ring, keeping the ring exposed outside the front of the holster.

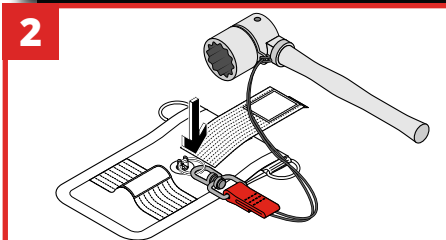

2 Connect the tool to the retractor or side D-rings.

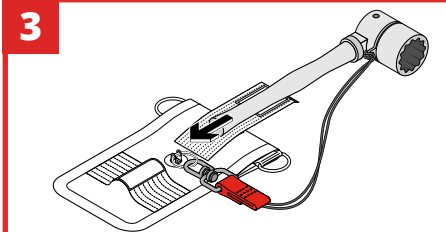

3 Slide the tool into holster with the connection point applied to tool.

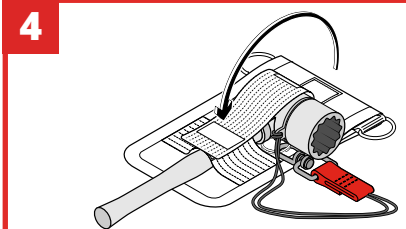

4 Close the front strap.



5 Apply the holster to your work belt, by sliding the belt through the slip located on the upper end of holster.

SPECIFICATIONS

SKU	MAX LOAD (D-RING)	MAX LOAD (RETRACTOR)
H02047	2.5KG 5.5LB	1.2M 47IN