

GRIPPS®

ANSI/ISEA
121-2018
COMPLIANT

H02106 LOCKJAW RIGGERS BAG

The GRIPPS® Lockjaw Riggers Bag is equipped with a multitude of features that simplify tool organisation, accessibility, and storage and boasts a sturdy metal snap frame seamlessly integrated into the zipper, providing the option to lock it open or closed.

Boasting a sturdy metal snap frame seamlessly integrated into the zipper, providing the option to lock it open or closed. This innovative design ensures easy access to all contents within the bag without the inconvenience of dealing with a flimsy lid.

Ideal for accommodating various small objects and hand tools, the inner lining is designed with a range of pouches, pockets, and sleeves to keep everything within easy reach and well-organised.

For added versatility and security, eight load-rated D-rings are incorporated, allowing you to tether all contents securely against drops.

Additionally, load-rated sewn-in loops enable the attachment of the



ENGINEERED FOR DROP PREVENTION

5_{KG}

11_{LB}

MAX LOAD



www.gripps.com

KEY FEATURES

Industrial-strength zip to totally secure contents.

Inner sleeve tool organisation pockets, sleeves and pouches.

A metal snap frame that allows the bag to be locked open or closed.

Can be attached to work belts and harnesses.

Load-rated tether anchors installed inside and outside the bag.



HOW TO USE

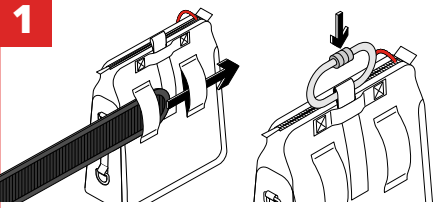

1 To apply to a work belt, feed the work belt through the rear loops and then secure the belt to your waist. Alternatively, attach a carabiner to top loop, threading the carabiner through and secure carabiner for harness work.

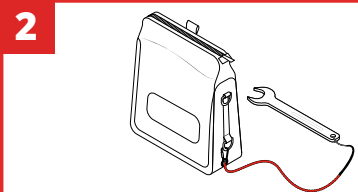

2 Connect tool tethers to the D-rings as required. Use the bag for holding or transporting loads. Only connect additional tethers to the load rated D-rings.

*** NEVER EXCEED MAX LOAD ***

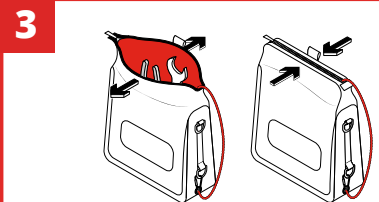

3 To operate the metal snap frame, pull the opening apart and the closure will automatically spring open and lock into place.

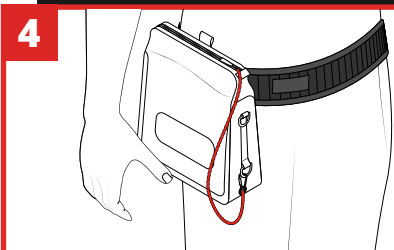

4 Ensure that the closure is zipped closed when not in use to prevent spills.

SPECIFICATIONS

SKU	MAX LOAD (D-RING)	MAX LOAD (POUCH)	DIMENSION
H02106	2.5kg 5.5lb	5kg 11lb	23cm x 26cm x 10cm 9in x 10in x 4in

@GRIPPSGLOBAL



#ConquerGravity