

GRIPPS®

ANSI/ISEA
121-2023
COMPLIANT

H02076 RETRACTABLE DUAL TOOL HOLSTER

The GRIPPS® Retractable Dual Tool Holster combines lightweight design with rugged construction, boasts two storage pouches for small hand tools and two GRIPPS® Steel Retractor Units.

Designed with durability and convenience in mind, the GRIPPS® Dual Tool Holster combines lightweight design with rugged construction, boasting two storage pouches for small hand tools.



2.5 KG **5.5** LB

MAX LOAD (D-RING):

0.7 KG **1.5** LB

MAX LOAD (RETRACTOR):

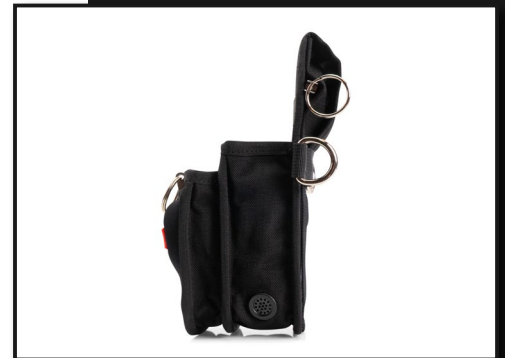

ENGINEERED FOR DROP PREVENTION

www.gripps.com

KEY FEATURES

Compatible with all standard work belts

Lightweight design with industrial toughness.



2 x Built-in GRIPPS® retractors units with heavy-duty tether cable.

2 x load-rated D-Rings.

Drain hole.

SPECIFICATIONS

SKU	MAX LOAD (D-RING)	MAX LOAD (RETRACTOR)	MAX LENGTH (RETRACTOR)
H02076	2.5kg 5.5lb	0.7kg 1.5lb	1.2m 47in

1

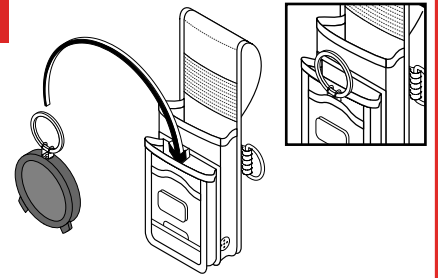

Insert the Retractor Unit into front pouch. Ensure tool ring is exposed outside holster.

2

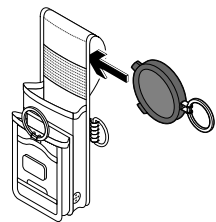

Insert second Retractor Unit into rear pouch. Ensure tool ring is exposed outside holster.

3

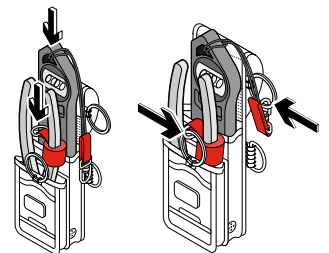

Connect tool to the Retractor or side D-Rings.

4

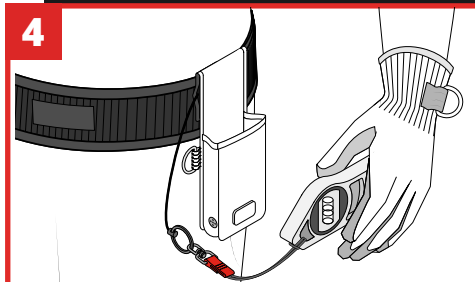

Your Dual Tool Holster is now ready for use

@GRIPPSGLOBAL



#ConquerGravity